

LOCATION PLAN
NO SCALE

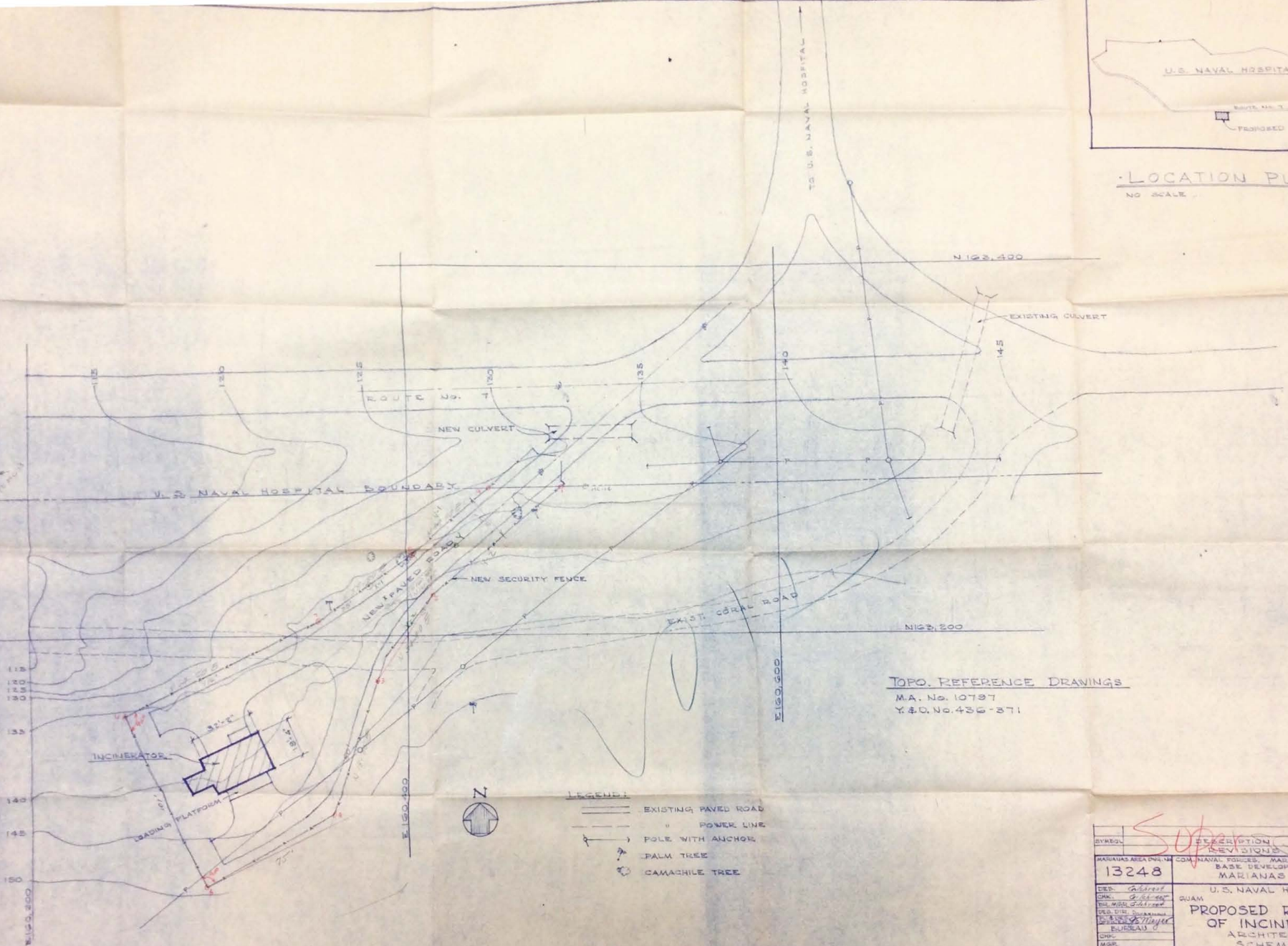

TOPO. REFERENCE DRAWINGS
M.A. No. 10787
Y.&O. No. 436-371

- LEGEND:
- EXISTING PAVED ROAD
 - - - POWER LINE
 - ⊙ POLE WITH ANCHOR
 - ⊙ PALM TREE
 - ⊙ CAMACHILE TREE



SHEET NO.	DESCRIPTION	DATE APPROVED
13248	REVISIONS	
MARIANAS AREA DIVISION	COM. NAVAL POLICES, MARIANAS BASE DEVELOPMENT DIV.	GUAM, M.I.
	MARIANAS AREA	
DES. <i>Suber</i>	U.S. NAVAL HOSPITAL	M.I.
CHK. <i>Suber</i>	QUAM	
ENGR. <i>Suber</i>	PROPOSED RELOCATION	
PROJ. DIR. <i>Suber</i>	OF INCINERATOR	
CHIEF <i>Suber</i>	ARCHITECTURAL	
BUREAU	SCHEMATIC	
DATE	APPROVED <i>J.P. Jones</i>	DATE 8-1-1953
PROJ. MGR.	ENGINEER FOR ASST. CHIEF OF STAFF	
DIVISION	APPROVED FOR BUREAU OF Y&O	SCALE: 1" = 20' (REF.)
APPROVED FOR BUREAU OF Y&O		SHEET 1 OF 1
	FOR CHIEF OF BUREAU	Nov
		Y.&O. DWG. No. 556-681

SATISFACTORY TO
P. DeWitt
DATE 5-5-53