

REVISIONS OF THE DETAILS OR CON-  
 TAINED HEREIN SHALL BE MADE BY  
 THE ARCHITECT OR HIS REPRESENTATIVE  
 (BY DIRECTION OF THE ARCHITECT)  
 DATE 3-31-53

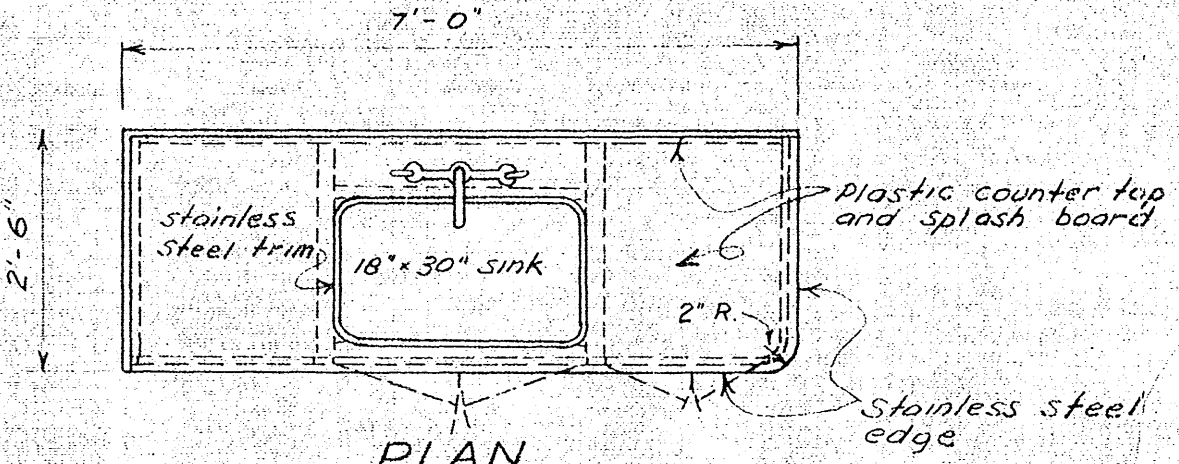

**PLAN**  
Scale 1/2" = 1'-0"

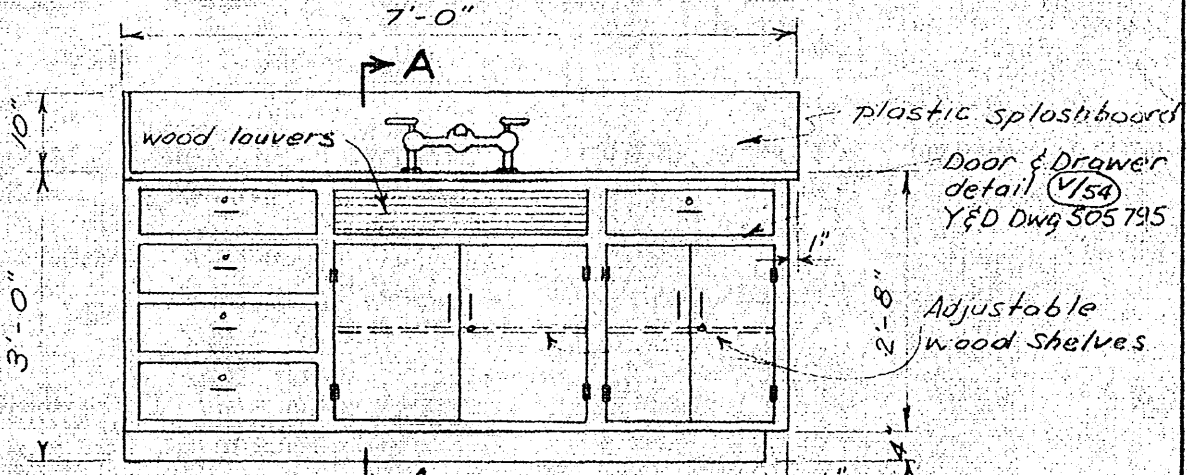

**ELEVATION**  
Scale 1/2" = 1'-0"

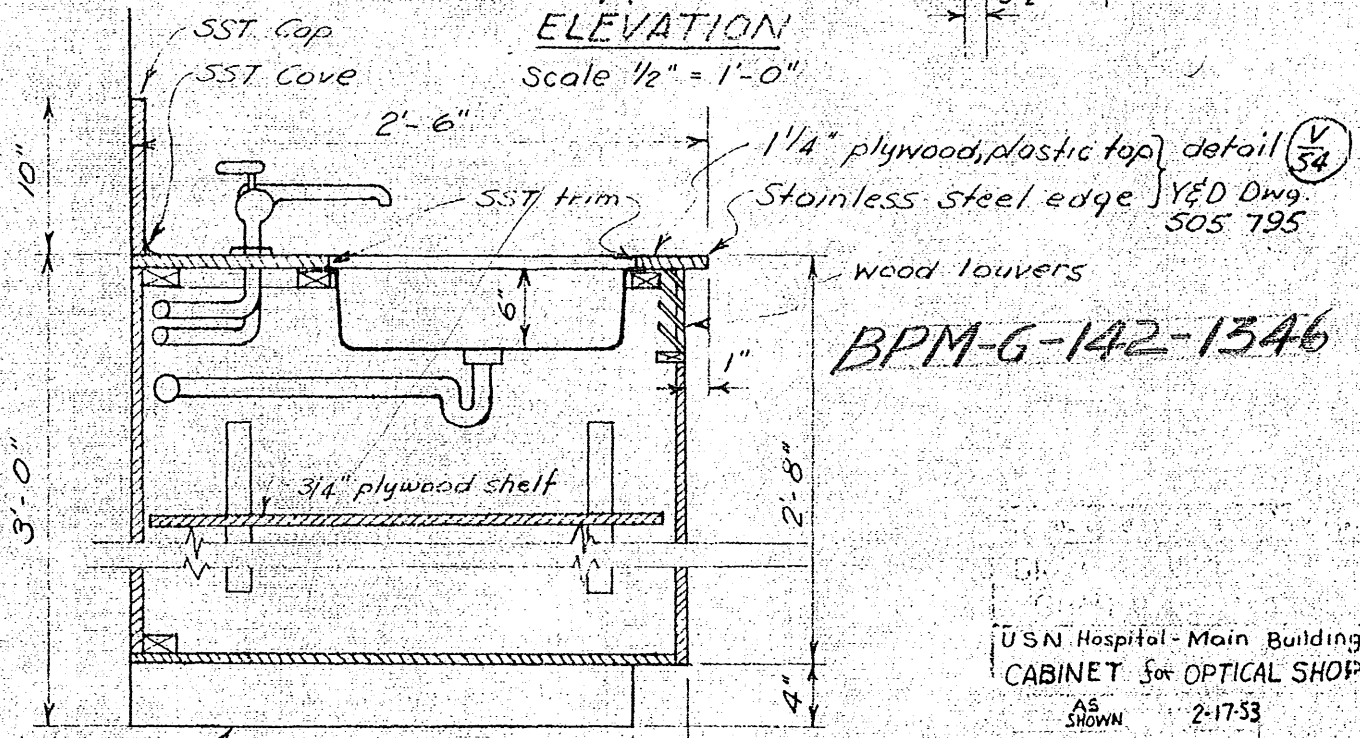

**SECTION A-A**  
Scale 1" = 1'-0"

Metal base  
Typ. detail  
Y&D Dwg. 505 795

**BPM-G-142-1346**

U.S.N. Hospital - Main Building	
CABINET for OPTICAL SHOP	
AS SHOWN	2-17-53
LSS	Wes
23910	