

LEGEND:

- POWER POLE
- CONCRETE POWER POLE, NEW
- OVERHEAD LINES
- △ TRANSFORMER, POLE MOUNTED
- ▽ TRANSFORMER, PAD MOUNTED
- DOWN GUY
- G TYPE OF NEW CONCRETE POLE, 35 FT. LONG
- (I) TYPE OF NEW CONCRETE POLE, 45 FT. LONG
- (*) ASTERISK INDICATES NEW CONCRETE POLE WITH CONCRETE FOUNDATION. NO ASTERISK INDICATES NEW CONCRETE POLE WITH CORAL BACKFILL

5

1	2	3	4	5
6	7	8	9	10
11	12	13	14	15
16	17	18	19	20
21	22	23	24	25

REFER TO KEY MAP FOR LOCATION

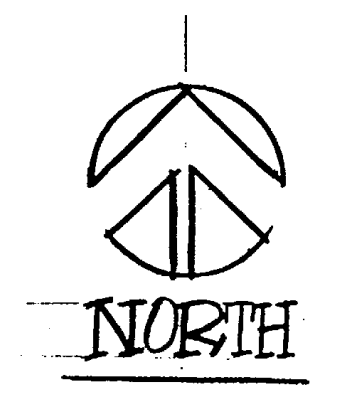

**ADDITIVE BID
ITEM NO. 6**

DEPT OF THE NAVY PUBLIC WORKS CENTER GUAM M.I.	NAVFAC BR ARS	DEPARTMENT OF THE NAVY OFFICER IN CHARGE OF CONSTRUCTION GUAM MARIANAS ISLAND
	PDE ECT EIC <i>Japan</i> 10-9-92 BR MGR <i>Williams</i> DEPT HEAD V.R. 3150255(A12942)	NCTAMS BARRIGADA POWER DISTRIBUTION PLAN
SATISFACTORY TO: PNC CODE 600 DATE APPROVED BY: STAFF CIVIL ENGINEER	REVIEWED BY: BR OIC ENGINEERING DIVISION DATE	SIZE D CODE IDENT NO. DRAWING NO. 5-G-20 CONSTR CONTR NO.
SCALE 1"=100' SPEC		SHT OF

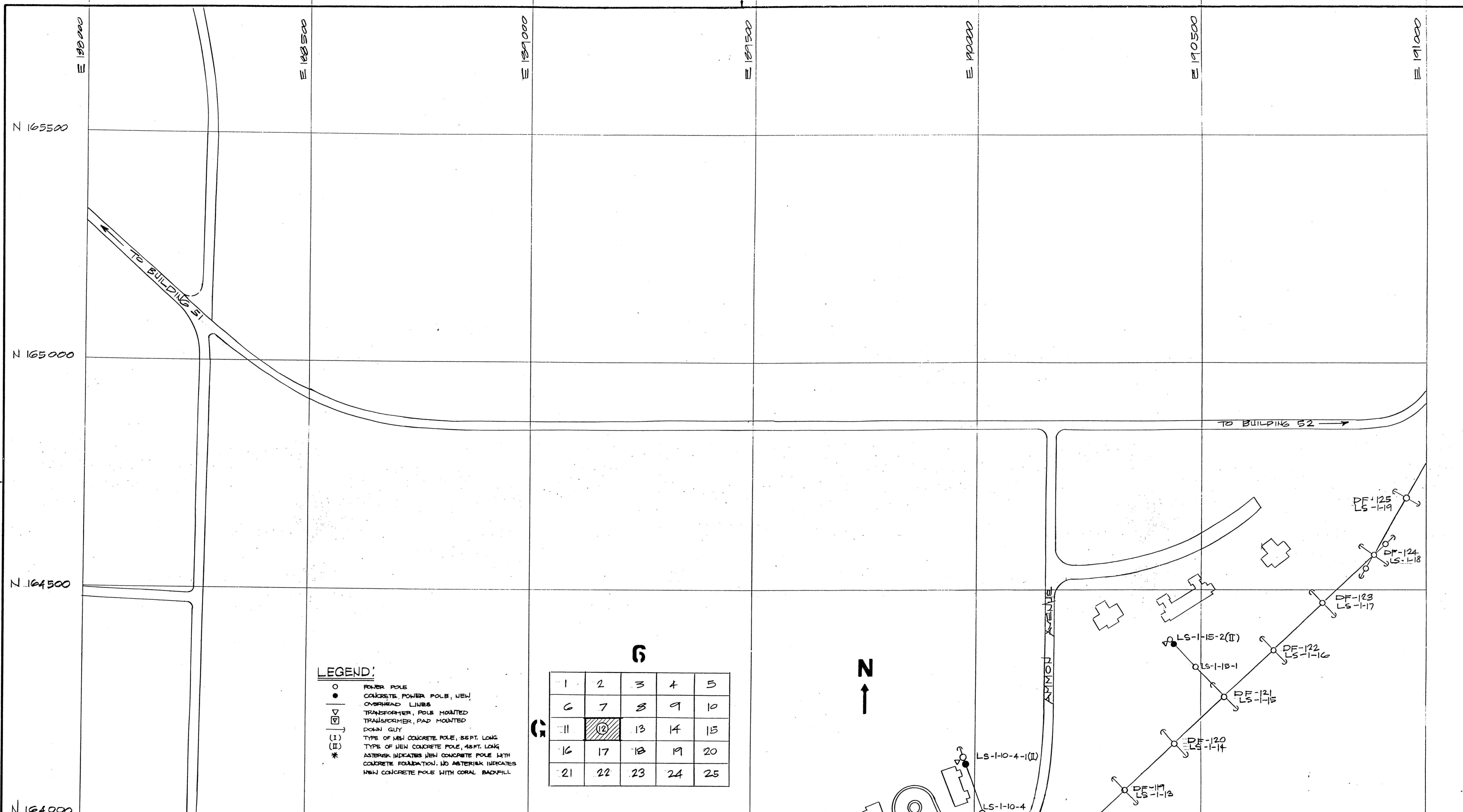

LEGEND:

- POWER POLE
- CONCRETE POWER POLE, NEW
- OVERHEAD LINES
- ▽ TRANSFORMER, POLE MOUNTED
- TRANSFORMER, PAD MOUNTED
- ↓ DOWN GUY
- (I) TYPE OF NEW CONCRETE POLE, 55 FT. LONG
- (II) TYPE OF NEW CONCRETE POLE, 45 FT. LONG
- * ASTERISK INDICATES NEW CONCRETE POLE WITH CONCRETE FOUNDATION, NO ASTERISK INDICATES NEW CONCRETE POLE WITH CORAL BACKFILL

G

1	2	3	4	5
6	7	8	9	10
11	12	13	14	15
16	17	18	19	20
21	22	23	24	25

**ADDITIVE BID
ITEM NO. 1**

DEPT OF THE NAVY NAVFAC PUBLIC WORKS CENTER GUAM M.I.		DEPARTMENT OF THE NAVY OFFICER IN CHARGE OF CONSTRUCTION GUAM MARIANAS ISLAND	
PDE	DR	10-9-92	
BR MGR	W.R. 3150355 (A12342)		
DEPT HEAD	REVIEWED BY:		
DATE	DATE	DATE	DATE
APPROVED BY:	DATE	DATE	DATE
SIZE	CODE IDENT NO.	DRAWING NO.	6-G-12
D		CONSTR CONTR NO.	
SCALE 1"=100'-0" SPEC		SHT	OF

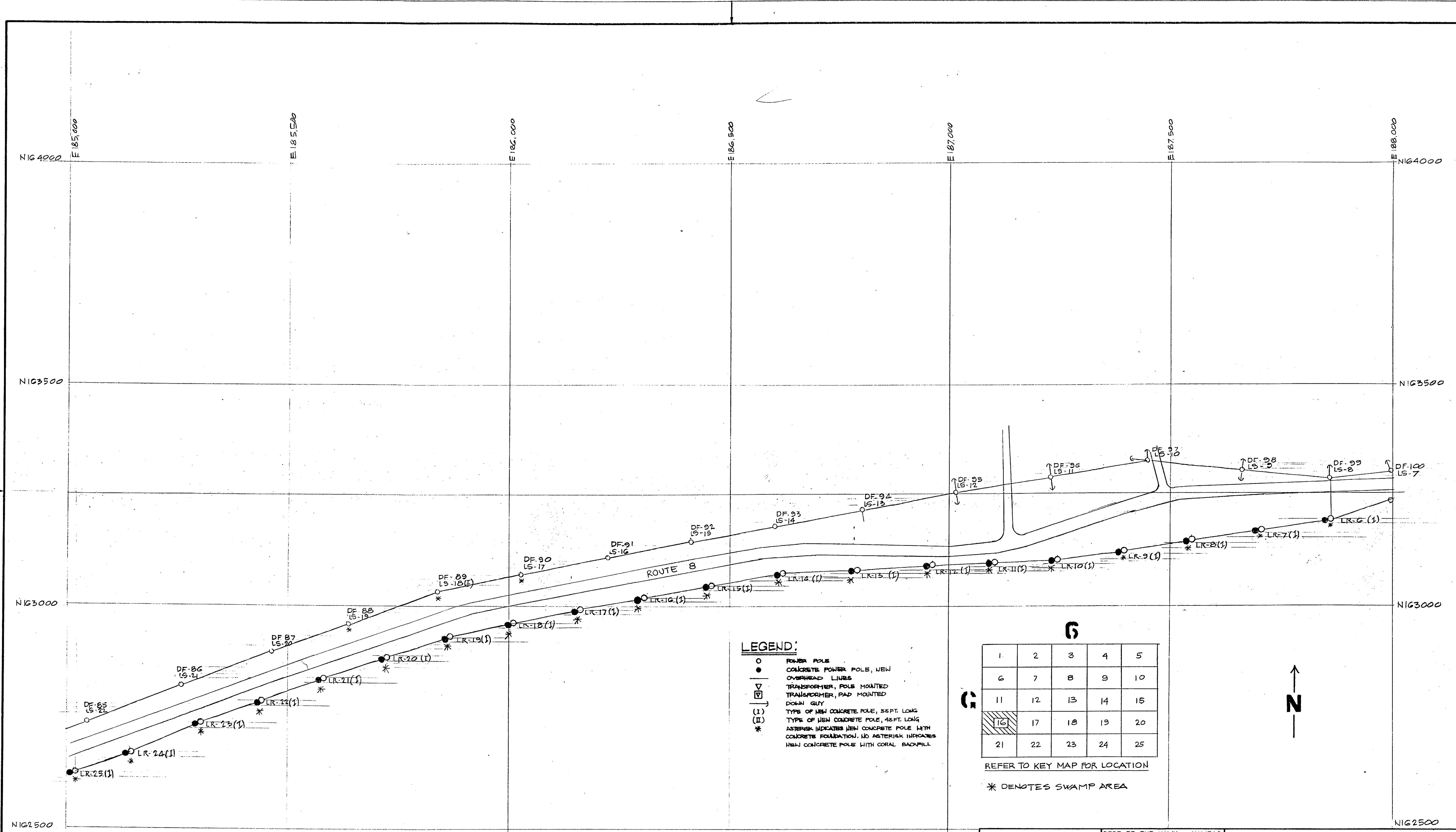

LEGEND:

- POWER POLE
- CONCRETE POWER POLE, NEW
- OVERHEAD LINES
- ▽ TRANSFORMER, POLE MOUNTED
- TRANSFORMER, PAD MOUNTED
- ↓ DOWN GUY
- (I) TYPE OF NEW CONCRETE POLE, 55FT. LONG
- (II) TYPE OF NEW CONCRETE POLE, 45FT. LONG
- * ASTERISK INDICATES NEW CONCRETE POLE WITH CONCRETE FOUNDATION. NO ASTERISK INDICATES NEW CONCRETE POLE WITH CORAL BACKFILL

G

1	2	3	4	5
6	7	8	9	10
11	12	13	14	15
16	17	18	19	20
21	22	23	24	25

REFER TO KEY MAP FOR LOCATION
* DENOTES SWAMP AREA

**ADDITIVE BID
ITEM NO. 6**

DEPT OF THE NAVY NAVFAC PUBLIC WORKS CENTER GUAM M.I.	PDE <i>ECI/SCM</i> DR <i>HAH</i> EIC <i>Hagan</i> 10-9-92 BR MGR <i>Hagan</i> DEPT HEAD V.R. 3150355 (A12942)	DEPARTMENT OF THE NAVY OFFICER IN CHARGE OF CONSTRUCTION GUAM MARIANAS ISLAND
	NCTAMS BARRIGADA AREA POWER DISTRIBUTION PLAN	
SATISFACTORY TO: PNC CODE 600 DATE	REVIEWED BY: BR DICE ENGINEERING DIVISION DATE APPROVED BY:	SIZE CODE IDENT NO. D PRANING NO. G-G-16 CONSTR CONTR NO.
STAFF CIVIL ENGINEER DATE	SCALE 1"=100'-0" SPEC	SHT DF

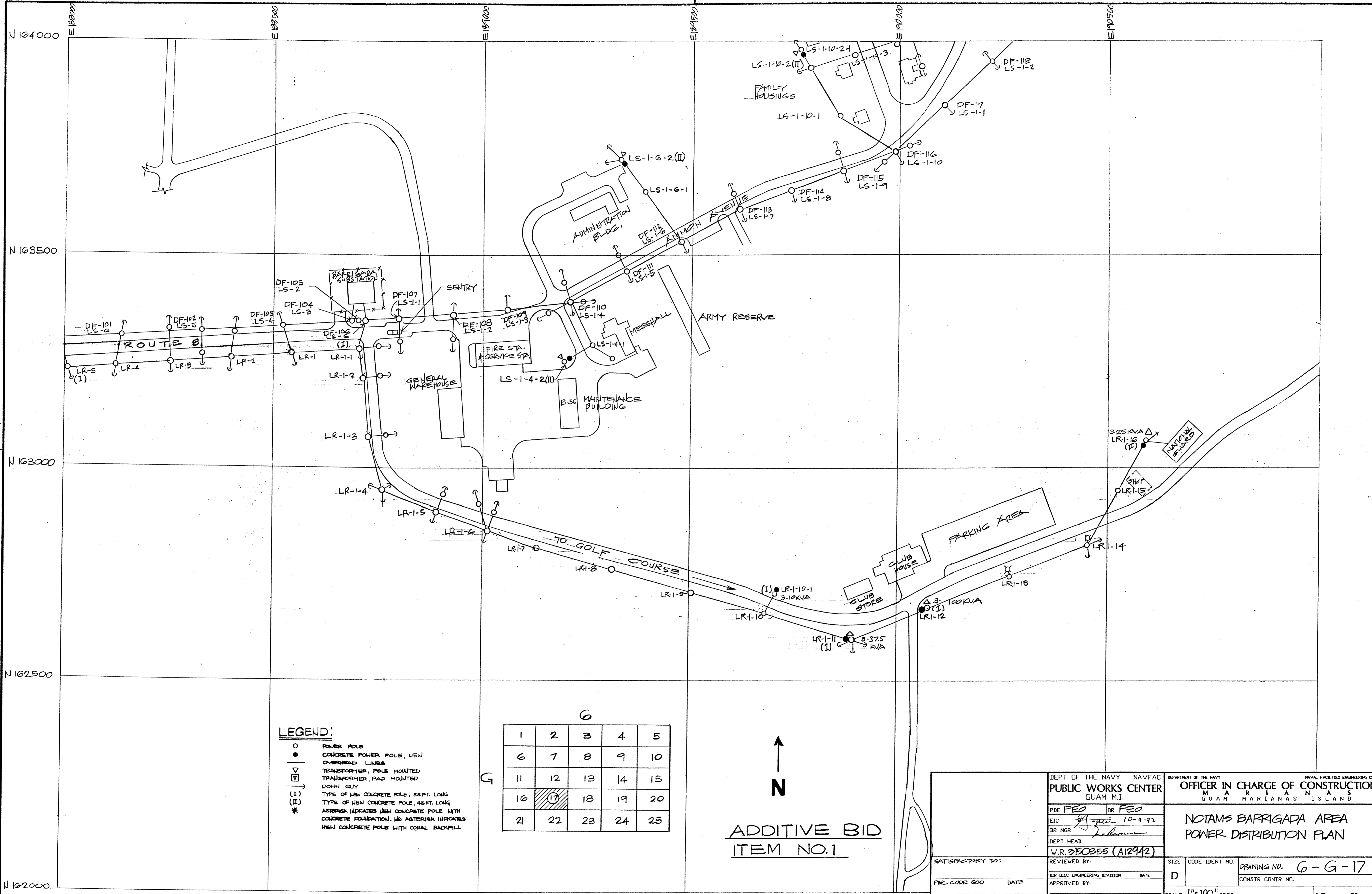

LEGEND:

- POWER POLE
- CONCRETE POWER POLE, NEW
- OVERHEAD LINES
- ▽ TRANSFORMER, POLE MOUNTED
- ▢ TRANSFORMER, PAD MOUNTED
- DOWN GUY
- (I) TYPE OF NEW CONCRETE POLE, 55 FT. LONG
- (II) TYPE OF NEW CONCRETE POLE, 45 FT. LONG
- * ASTERISK INDICATES NEW CONCRETE POLE WITH CONCRETE FOUNDATION. NO ASTERISK INDICATES NEW CONCRETE POLE WITH CORAL BACKFILL.

6				
1	2	3	4	5
6	7	8	9	10
11	12	13	14	15
16	17	18	19	20
21	22	23	24	25

↑
N

ADDITIVE BID
ITEM NO.1

DEPT OF THE NAVY NAVFAC PUBLIC WORKS CENTER GUAM M.I.		DEPARTMENT OF THE NAVY OFFICER IN CHARGE OF CONSTRUCTION GUAM MARIANAS ISLAND	
PDE <i>FEO</i> DR <i>FEO</i>		NOTAMS BARRIGADA AREA POWER DISTRIBUTION PLAN	
EIC <i>[Signature]</i> 10-9-92			
BR MGR <i>[Signature]</i>		DRAWING NO. G-G-17 CONSTR CONTR NO.	
DEPT HEAD			
W.R. 2150355 (A12942)		SCALE 1"=100' SPEC	
REVIEWED BY:			
DIR ENGR DIVISION DATE		SHT DF	
APPROVED BY:			
SATISFACTORY TO:		DATE	
PWC CODE 600			
STAFF CIVIL ENGINEER DATE		DATE	
DATE			

I-2
II-3