

REVISIONS		
SYM	DESCRIPTION	DATE APPROVED

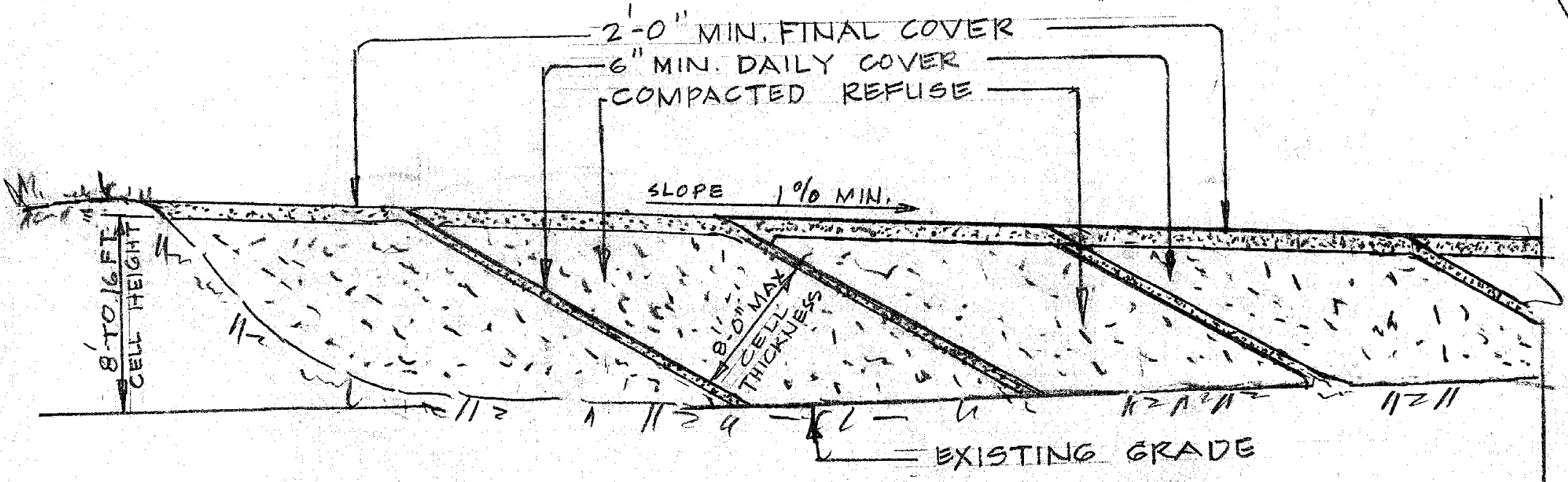
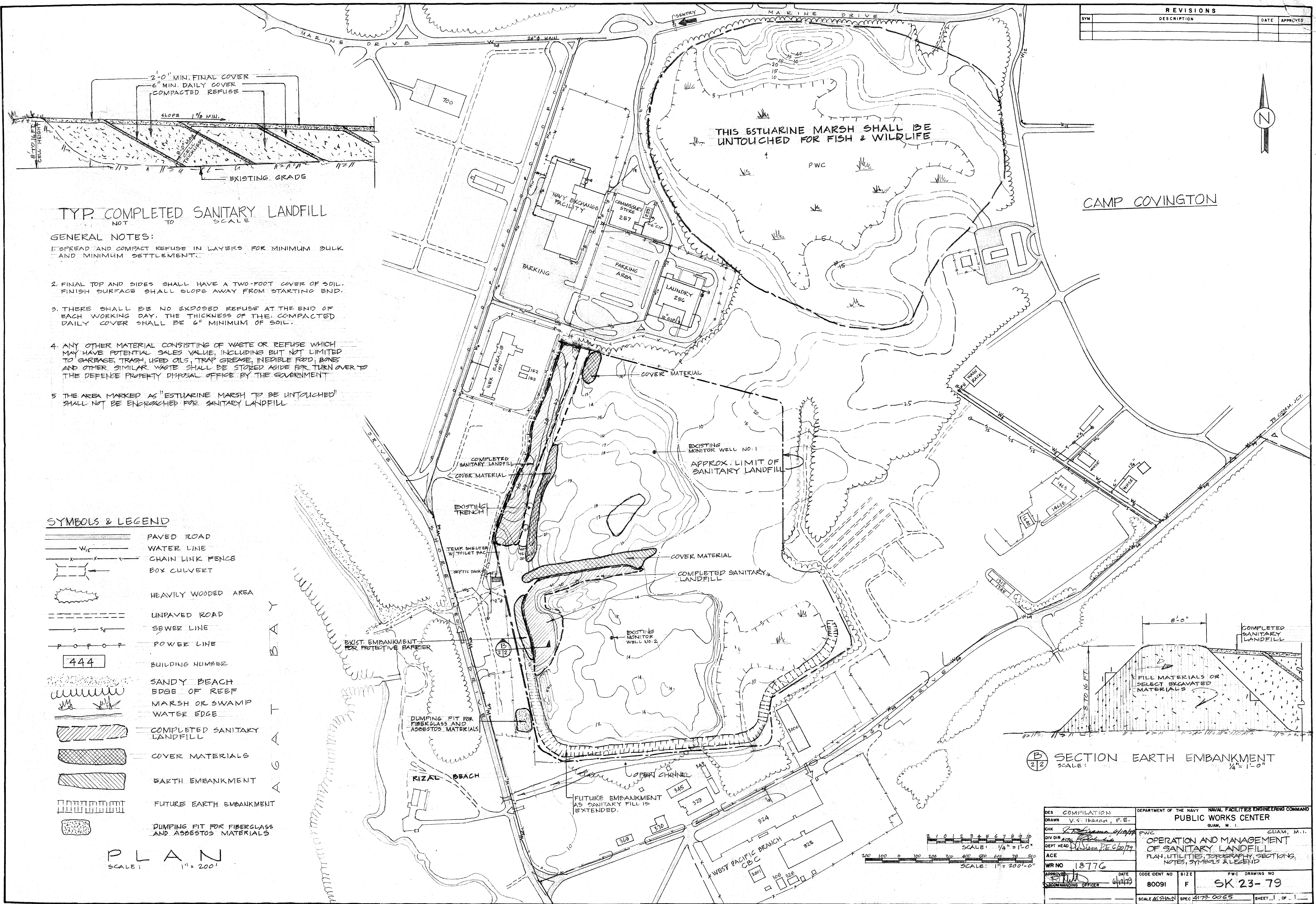
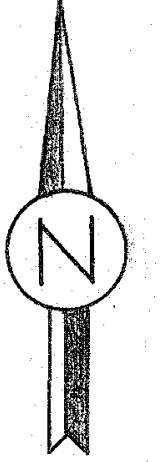

TYP. COMPLETED SANITARY LANDFILL

GENERAL NOTES:

1. SPREAD AND COMPACT REFUSE IN LAYERS FOR MINIMUM BULK AND MINIMUM SETTLEMENT.
2. FINAL TOP AND SIDES SHALL HAVE A TWO-FOOT COVER OF SOIL. FINISH SURFACE SHALL SLOPE AWAY FROM STARTING END.
3. THERE SHALL BE NO EXPOSED REFUSE AT THE END OF EACH WORKING DAY. THE THICKNESS OF THE COMPACTED DAILY COVER SHALL BE 6" MINIMUM OF SOIL.
4. ANY OTHER MATERIAL CONSISTING OF WASTE OR REFUSE WHICH MAY HAVE POTENTIAL SALES VALUE, INCLUDING BUT NOT LIMITED TO GARBAGE, TRASH, USED OILS, TRAP GREASE, INEDIBLE FOOD, BONES AND OTHER SIMILAR WASTE SHALL BE STORED ASIDE FOR TURN OVER TO THE DEFENSE PROPERTY DISPOSAL OFFICE BY THE GOVERNMENT.
5. THE AREA MARKED AS "ESTUARINE MARSH TO BE UNTOUCHED" SHALL NOT BE ENDEACHED FOR SANITARY LANDFILL.

SYMBOLS & LEGEND

- PAVED ROAD
- WATER LINE
- CHAIN LINK FENCE
- BOX CULVERT
- HEAVILY WOODED AREA
- UNPAVED ROAD
- SEWER LINE
- POWER LINE
- BUILDING NUMBER
- SANDY BEACH EDGE OF REEF
- MARSH OR SWAMP
- WATER EDGE
- COMPLETED SANITARY LANDFILL
- COVER MATERIALS
- EARTH EMBANKMENT
- FUTURE EARTH EMBANKMENT
- DUMPING PIT FOR FIBERGLASS AND ASBESTOS MATERIALS

PLAN
SCALE: 1" = 200'

SECTION EARTH EMBANKMENT
SCALE: 1/4" = 1'-0"

DES. COMPILATION: DRAWN: V.S. Ibañez, P.E. CHK: [Signature] DIV DIR: [Signature] DEPT HEAD: [Signature] ACE: [Signature]	DEPARTMENT OF THE NAVY NAVAL FACILITIES ENGINEERING COMMAND PUBLIC WORKS CENTER GUAM, M.I.
WR NO: 18776 DATE: [Signature] COMMANDING OFFICER: [Signature]	PWC OPERATION AND MANAGEMENT OF SANITARY LANDFILL PLAN, UTILITIES, TOPOGRAPHY, SECTIONS, NOTES, SYMBOLS & LEGEND
CODE IDENT NO: 80091 SIZE: F SPEC: 4179-0065	PWC DRAWING NO: SK 23-79 SHEET 1 OF 1

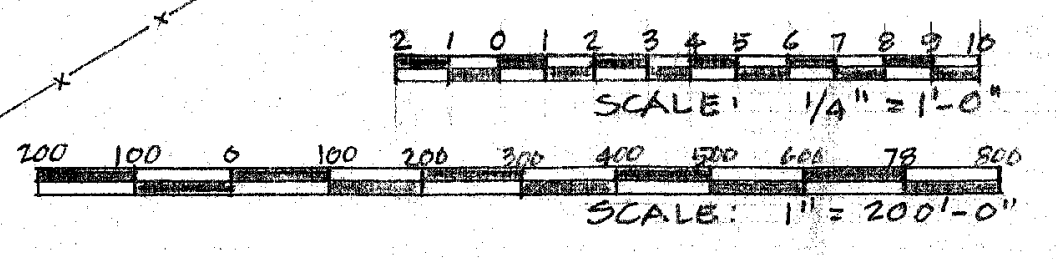

6561001